

Democracy in the Third Millennium

The European Perspective on How to Use Technology

Homer Simpson Tries to Vote for Obama



<http://www.youtube.com/watch?v=1aBaX9GPSaQ>

Have you ever spend a second thinking
about how electronic banking works?

So why is making use of technology
in democratic processes so special?

Agenda

- Introduction
- How does it work?
- Who are the players – and why?
- What is the context?
- And why is there such a big debate?
- Summary

Changing Societies

1. Face-to-Face Society
 - Rome, Athens, Vikings, Italian/German city states
 - Swiss Landsgemeinde
2. Territorial Society
 - French Revolution, United States,
3. Global Society
 - Information, Communication und Transaction Worldwide over the Internet



Definition

Electronic voting is using electronic means
(information and communication technologies/ICT)
in at least the casting of the vote

Council of Europe Recommendation 2004(11) on electronic voting

How Does E-voting Work?

In General, E-Voting is based on the separation of

- Unique identification of the voter, and
- The casting of the vote, and keeping it secret

Secrecy

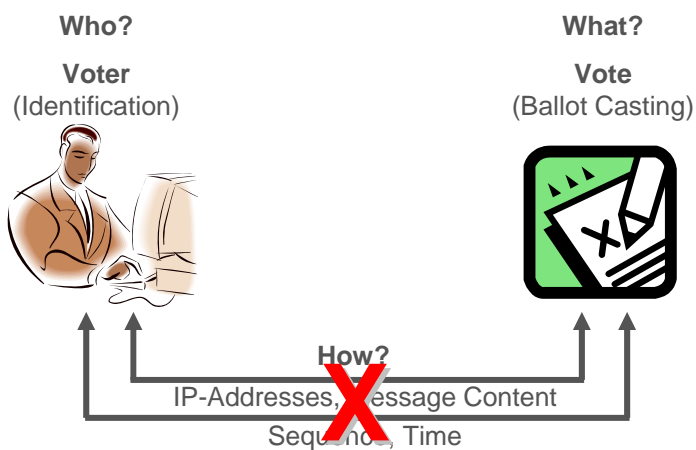

Forms of Electronic Voting

	Place	Controlled (Polling Station)	Uncontrolled (At Home)
Medium			
Paper		Ballot Sheet	Postal Voting
Electronics		DRE Electronic Voting Machines	Internet Voting

Kiosk Voting

Optical Scanner

Electronic Voting Machines

Venezuela



Russia



Internet Voting

Estonia

Vabariigi Valimiskomisjon

- Valimised ja e-hääletamine
- Kuidas hääletada internetis
 - Juhised Windows'i kasutajatele
 - Juhised Linux'i kasutajatele
 - Juhised Mac OS X'i kasutajatele
- Korduma kippuvad küsimused

Otsid lisateavet valimiste kohta?

Ajavahemikus 8-14 oktoobri

Elektrooniline hääletamine

Kokku hääletas elektrooniliselt 104313 e-hääletajat.

E-hääletajate jaotusid järgnevalt

Eesti Reformierakond

Austria

OeH-Wahl .gv.at **Elektronische Stimmabgabe (E-Voting)**

Supportline: 0610/001885 (08:00 - 17:00) | support@oezh-wahl.gv.at

Sicherer Zugang zur Online-Anwendung mit Bürgerkarte

Zuerst müssen Sie eine Bürgerkartenumgebung auswählen. Wenn Sie in Folge die Schaltfläche aktivieren, so werden Sie zur Signaturlenker Anmeldebildschirm. Wenn Sie diese signieren, so werden Sie zur Online-Anwendung weitergeleitet und angemeldet.

Bitte stellen Sie sicher, dass Ihr Kartenlesegerät mit dem Computer verbunden ist und legen Sie dann Ihre Bürgerkarte ein.

Geben Sie zuerst den 4-stelligen PIN ein, um sich zu identifizieren.

Geben Sie danach den 6-stelligen PIN ein, um Ihre Identität zu bestätigen.

Für die lokale BKU

1. Ein Kartenlesegerät mit gesteckter Bürgerkarte
2. Eine Bürgerkartensoftware "BKU"

Für die Online-BKU

1. Ein Kartenlesegerät mit gesteckter Bürgerkarte
2. Eine aktuelle Java-Installation (wird von Online-BKU überprüft)



Status Quo

© Modern Democracy Magazine 2009 (2)

Legend: Discussion Uncontrolled EVM Both Stopped

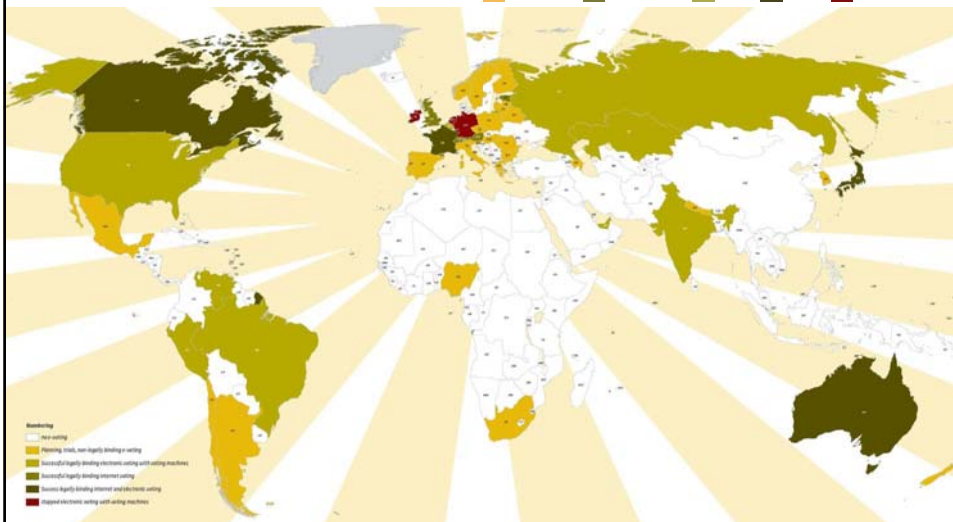

Who are the Players?

Voter	Administration	Politicians
Increasing voter mobility	Count quicker and more reliable Central Control	Inclusion
Support for the voter in casting the vote	Improve voter register	Innovation
Increase accessibility for handicapped voter	Reduce costs on the long run	Change in the electorate (+/-)

What is the Context?

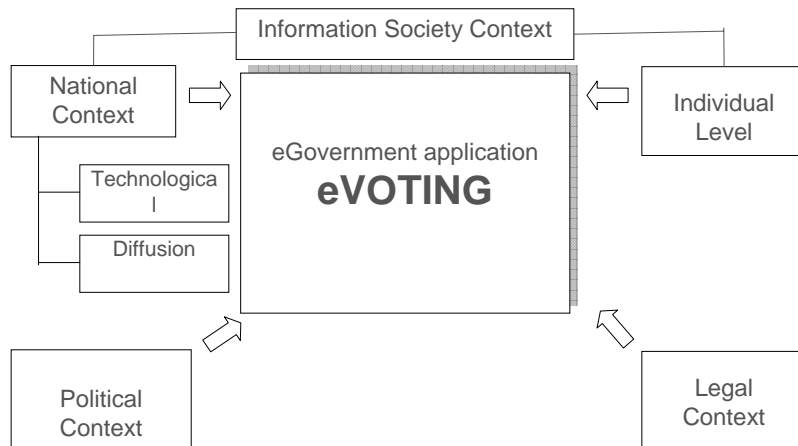

Why the Debate?

- What you can see, touch and feel, is hard to explain!
(Paper ↔ Electronics)
 - The problem is the scale:
Retail ↔ Wholesale Fraud
 - Usually adoption of technology in the electoral process is driven by the wrong reasons! => NEED ?!
 - It's a classical principle agent problem: Middleman paradoxon
- If the right technology is used in the wrong context == faulty technology

Delegating Control to Technology: Boon or Bane?!

- It helps standardizing
- Enables new possibilities,
i.e. making the process independent from location
- Can be more inclusive
- It is the way the digital natives are used to do things



Delegating Control to Technology: Boon or Bane?!

- Every stakeholder (group) needs to benefit from technology, and not be left out
- Diffusion of technology is dependant on (ICT) literacy
- Transparency is hard to achieve
- And Technology should never been used for the sake of it!



Summary

- Technology is to support the people
- E-voting needs proper discussion and experience
- Proper education and qualification of
 - polling station officers
 - technical operators
 - observers
 - voters
- Inclusion of the civil society, intensive discourse



Contact

Robert Krimmer
Senior Advisor on New Voting Technologies

OSCE Office for Democratic Institutions and Human Rights
Elections Department
Al. Ujazdowskie 19
00-557 Warszawa, Poland

E-mail: robert.krimmer@odihr.pl

